



PROGEF Standard
PP-H Ball valve type 546 Pro with PPA
DA (Double acting)
With fusion sockets metric

Model:

- Control pressure supply through integrated NAMUR interface according VDI/VDE 3845 with 5.6 bar (81.2 psi) E24:E25
- Control time 90° < 1-2s
- For easy installation and removal
- Integrated stainless steel mounting inserts
- Full plastic solution (actuator housing made of PP-GF)
- Visual position indicator
- Z-dimension, valve end and union nut are compatible with type 230 – 235 and 546 (1st Generation)

Option:

- Position feedback sensor, incl. LED feedback (DN10-50) - PNP, NPN and NAMUR
- Positioner RPC, RPC D, RPC PID
- Individual configuration of the valve

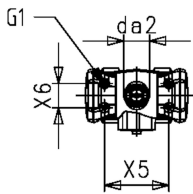

d (mm)	DN (mm)	PN (bar)	kv-value ($\Delta p=1$ bar) (l/min)	EPDM Code	SP Weight (kg)	FKM Code	SP Weight (kg)
16	10	10	70	199 251 202	1	199 251 212	1
20	15	10	185	199 251 203	1	199 251 213	1
25	20	10	350	199 251 204	1	199 251 214	1
32	25	10	700	199 251 205	1	199 251 215	1
40	32	10	1000	199 251 206	1	199 251 216	1
50	40	10	1600	199 251 207	1	199 251 217	1
63	50	10	3100	199 251 208	1	199 251 218	1

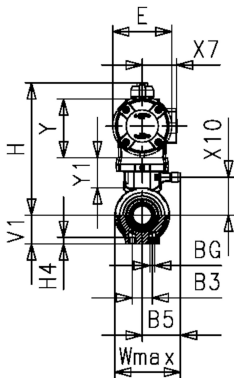

d (mm)	Actuator	DE1 (mm)	V1 (mm)	H4 (mm)	M1 (mm)	M2 (mm)	G2 (mm)	G (mm)	H3 (mm)	Lz1 (mm)	Lz2 (mm)	Lmax (mm)	E (mm)	Y1 (mm)
16	PPA08	50	27	12	64	64	M5	G 1/4	41	28	28	128	74	35
20	PPA08	50	27	12	64	64	M5	G 1/4	41	28	28	128	74	35
25	PPA08	58	30	12	64	64	M5	G 1/4	41	33	33	128	74	35
32	PPA08	68	36	12	64	64	M5	G 1/4	41	36	36	128	74	35
40	PPA15	84	44	15	83	83	M5	G 1/4	45	43	43	165	94	33
50	PPA15	97	51	15	83	83	M5	G 1/4	45	45	45	165	94	33
63	PPA40	124	64	15	92	92	M5	G 1/4	56	51	51	184	120	36

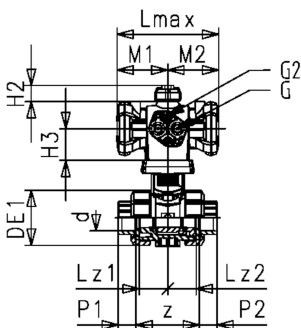

d (mm)	Y (mm)	H (mm)	X10 (mm)	B3 (mm)	BG (mm)	Wmax (mm)	G1 (mm)	da2 (mm)	X6 (mm)	X5 (mm)	X7 (mm)	H2 (mm)	P1 (mm)	P2 (mm)	z (mm)
16	95	177	35	25	M6	77	M5	33	30	80	37	20	13	13	67
20	95	177	35	25	M6	77	M5	33	30	80	37	20	14	14	67
25	95	180	35	25	M6	77	M5	33	30	80	37	20	16	16	76
32	95	186	35	25	M6	93	M5	33	30	80	37	20	18	18	82
40	108	205	33	45	M8	93	M5	33	30	80	47	20	20	20	97
50	108	212	33	45	M8	117	M5	33	30	80	47	20	23	23	101
63	131	251	36	45	M8	117	M5	33	30	80	60	20	27	27	114

The technical data are not binding. They neither constitute expressly warranted characteristics nor guaranteed properties nor a guaranteed durability. They are subject to modification. Our General Terms of Sale apply.

Data sheet

valid from: 3/24/22



Georg Fischer Piping Systems Ltd, Postfach, CH-8201 Schaffhausen/Switzerland

Phone +41 -(0)52-631 1111

e-mail: info.ps@georgfischer.com

Internet: <http://www.gfps.com>