

PROGEF Standard Diaphragm valve type 517 With backing flanges PP-V metric/BS

Model:

- Material: PP-H
- Double flow rate compared to predecessor
- One housing nut replaces four screws
- Handwheel with built-in locking mechanism
- Joining faces flat/serrated
- Overall length EN 558
- Connecting dimension: ISO 7005 PN 10, EN 1092 PN 10, DIN 2501 PN 10, BS 4504 PN 10

Option:

- Individual configuration of the valve
- Self adjusting multifunctional module with integrated limit switches

* O-Ring material: FKM

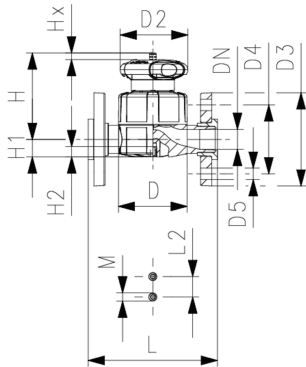

d (mm)	DN (mm)	Size (inch)	PN (bar)	kv-value ($\Delta p=1$ bar) (L/min)
20	15	½	10	125
25	20	¾	10	271
32	25	1	10	481
40	32	1 ¼	10	759
50	40	1 ½	10	1263
63	50	2	10	1728

d (mm)	NBR Code	EPDM Code	PTFE/ EPDM* Code	FKM Code	Weight (kg)
20	167 517 102	167 517 112	167 517 132	167 517 162	0.480
25	167 517 103	167 517 113	167 517 133	167 517 163	0.629
32	167 517 104	167 517 114	167 517 134	167 517 164	1.296
40	167 517 105	167 517 115	167 517 135	167 517 165	1.640
50	167 517 106	167 517 116	167 517 136	167 517 166	2.601
63	167 517 107	167 517 117	167 517 137	167 517 167	3.544

d (mm)	D (mm)	D2 (mm)	D3 (mm)	D4 (mm)	D5 (mm)	H (mm)	H1 (mm)	H2 (mm)	L (mm)	L2 (mm)	M	Lift = Hx (mm)	closest inch (inch)
20	65	65	95	65	14	73	14	12	130	25	M6	7	½
25	80	65	105	75	14	81	18	12	150	25	M6	10	¾
32	88	87	115	85	14	107	22	12	160	25	M6	13	1
40	101	87	140	100	18	115	26	15	180	45	M8	15	1 ¼
50	117	135	150	110	18	148	32	15	200	45	M8	19	1 ½
63	144	135	165	125	18	166	39	15	230	45	M8	25	2

The technical data are not binding. They neither constitute expressly warranted characteristics nor guaranteed properties nor a guaranteed durability. They are subject to modification. Our General Terms of Sale apply.

Georg Fischer Piping Systems Ltd, Postfach, CH-8201 Schaffhausen/Switzerland Phone +41 -(0)52-631 1111 e-mail:
info.ps@georgfischer.com Internet: <http://www.gfps.com>