

Fittings with short Spigot

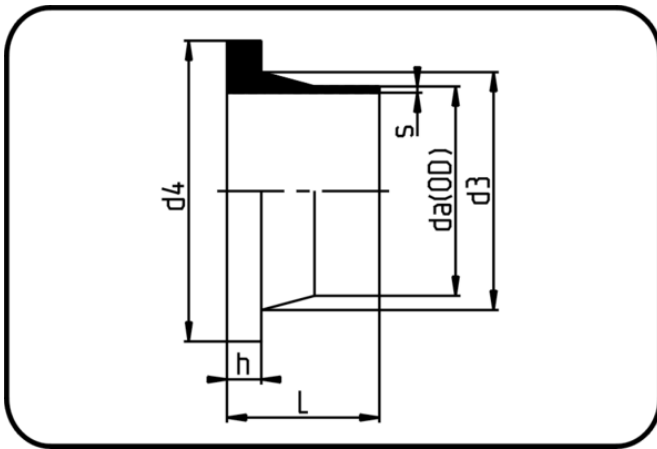

Code: 012

- Stub Flange DIN
- short spigot
- injection moulded
- Butt-welding
- PE 100-RC black

Backing Rings please see Accessories.

Dimension	Code	Detail	da(OD) mm	s mm	L mm	d3 mm	d4 mm	h mm	Weight
110	70.012.0110.33	110X3,4 SDR33 ISO S-16	110	3,4	80	125	158	18	0.3
125	70.012.0125.33	125X3,9 SDR33 ISO S-16	125	3,9	80	132	158	18	0.294
140	70.012.0140.33	140X4,3 SDR33 ISO S-16	140	4,3	80	155	188	18	0.436
160	70.012.0160.33	160X4,9 SDR33 ISO S-16	160	4,9	80	175	212	18	0.55
180	70.012.0180.33	180X5,5 SDR33 ISO S-16	180	5,5	92	183	212	18	0.48
200	70.012.0200.33	200X6,2 SDR33 ISO S-16	200	6,2	113	232	268	18	1.1
225	70.012.0225.33	225X6,9 SDR33 ISO S-16	225	6,9	113	235	268	18	0.865
250	70.012.0250.33	250X7,7 SDR33 ISO S-16	250	7,7	132	285	320	20	1.81
280	70.012.0280.33	280X8,6 SDR33 ISO S-16	280	8,6	128	288	320	20	1.44
315	70.012.0315.33	315X9,7 SDR33 ISO S-16	315	9,7	136	335	370	20	2.25
355	70.012.0355.33	355X10,9 SDR33 ISO S-16	355	10,9	150	373	430	23	2.94
400	70.012.0400.33	400X12,3 SDR33 ISO S-16	400	12,3	155	427	482	26	4.04
450	70.012.0450.33	450X13,8 SDR33 ISO S-16	450	13,8	170	514	585	33	8.08
500	70.012.0500.33	500X15,3 SDR33 ISO S-16	500	15,3	175	530	585	33	7.14
560	70.012.0560.33	560X17,2 SDR33 ISO S-16	560	17,2	178	615	685	35	11.36
630	70.012.0630.33	630X19,3 SDR33 ISO S-16	630	19,3	180	642	685	35	8.86
710	70.012.0710.33	710X21,8 SDR33 ISO S-16	710	21,8	170	737	800	50	17.8
63	70.012.0063.17	63X3,8 SDR17 ISO S-8	63	3,8	50	75	102	14	0.114
75	70.012.0075.17	75X4,5 SDR17 ISO S-8	75	4,5	50	89	122	16	0.175
90	70.012.0090.17	90X5,4 SDR17 ISO S-8	90	5,4	81	105	138	17	0.289
110	70.012.0110.17	110X6,6 SDR17 ISO S-8	110	6,6	80	125	158	18	0.388
125	70.012.0125.17	125X7,4 SDR17 ISO S-8	125	7,4	84	132	158	18	0.36

Dimension	Code	Detail	da(OD) mm	s mm	L mm	d3 mm	d4 mm	h mm	Weight
140	70.012.0140.17	140X8,3 SDR17 ISO S-8	140	8,3	92	155	188	18	0.589
160	70.012.0160.17	160X9,5 SDR17 ISO S-8	160	9,5	92	175	212	18	0.741
180	70.012.0180.17	180X10,7 SDR17 ISO S-8	180	10,7	92	183	212	20	0.73
200	70.012.0200.17	200X11,9 SDR17 ISO S-8	200	11,9	110	232	268	24	1.56
225	70.012.0225.17	225X13,4 SDR17 ISO S-8	225	13,4	112,5	235	268	24	1.499
250	70.012.0250.17	250X14,8 SDR17 ISO S-8	250	14,8	132	285	320	25	2.6
280	70.012.0280.17	280X16,6 SDR17 ISO S-8	280	16,6	128	288	320	25	2.34
315	70.012.0315.17	315X18,7 SDR17 ISO S-8	315	18,7	136	335	370	25	3.4
355	70.012.0355.17	355X21,1 SDR17 ISO S-8	355	21,1	150	373	430	30	4.88
400	70.012.0400.17	400X23,7 SDR17 ISO S-8	400	23,7	155	427	482	33	6.6
450	70.012.0450.17	450X26,7 SDR17 ISO S-8	450	26,7	168	514	585	46	11.96
500	70.012.0500.17	500X29,7 SDR17 ISO S-8	500	29,7	170	530	585	46	11.22
560	70.012.0560.17	560X33,2 SDR17 ISO S-8	560	33,2	175	615	685	50	16.36
630	70.012.0630.17	630X37,4 SDR17 ISO S-8	630	37,4	180	642	685	50	15.74
710	70.012.0710.17	710X42,1 SDR17 ISO S-8	710	42,1	170	737	800	50	20.8
20	70.012.0020.11	20X2,0 SDR11 ISO S-5	20	2	52	27	45	7	0.016
25	70.012.0025.11	25X2,3 SDR11 ISO S-5	25	2,3	50	33	58	9	0.029
32	70.012.0032.11	32X3,0 SDR11 ISO S-5	32	3	50	40	68	10	0.043
40	70.012.0040.11	40X3,7 SDR11 ISO S-5	40	3,7	50	50	78	11	0.064
50	70.012.0050.11	50X4,6 SDR11 ISO S-5	50	4,6	53	61	88	12	0.091
63	70.012.0063.11	63X5,8 SDR11 ISO S-5	63	5,8	50	75	102	14	0.129
75	70.012.0075.11	75X6,8 SDR11 ISO S-5	75	6,8	50,5	89	122	16	0.204
90	70.012.0090.11	90X8,2 SDR11 ISO S-5	90	8,2	80	105	138	17	0.34
110	70.012.0110.11	110X10,0 SDR11 ISO S-5	110	10	80	125	158	18	0.461
125	70.012.0125.11	125X11,4 SDR11 ISO S-5	125	11,4	80	132	158	25	0.513
140	70.012.0140.11	140X12,7 SDR11 ISO S-5	140	12,7	92	155	188	25	0.817
160	70.012.0160.11	160X14,6 SDR11 ISO S-5	160	14,6	92	175	212	25	1.026
180	70.012.0180.11	180X16,4 SDR11 ISO S-5	180	16,4	93	183	212	30	1.06
200	70.012.0200.11	200X18,2 SDR11 ISO S-5	200	18,2	114	232	268	32	2.18
225	70.012.0225.11	225X20,5 SDR11 ISO S-5	225	20,5	113	235	268	32	2.1
250	70.012.0250.11	250X22,7 SDR11 ISO S-5	250	22,7	130	285	320	35	3.56
280	70.012.0280.11	280X25,4 SDR11 ISO S-5	280	25,4	128	288	320	35	3.42
315	70.012.0315.11	315X28,6 SDR11 ISO S-5	315	28,6	136	335	370	35	5
355	70.012.0355.11	355X32,2 SDR11 ISO S-5	355	32,2	150	373	430	40	6.88
400	70.012.0400.11	400X36,3 SDR11 ISO S-5	400	36,3	155	427	482	46	9.04
450	70.012.0450.11	450X40,9 SDR11 ISO S-5	450	40,9	166	514	585	60	16.22
500	70.012.0500.11	500X45,4 SDR11 ISO S-5	500	45,4	175	530	585	60	15.76
560	70.012.0560.11	560X50,8 SDR11 ISO S-5	560	50,8	180	615	685	60	22.78

Dimension	Code	Detail	da(OD) mm	s mm	L mm	d3 mm	d4 mm	h mm	Weight
630	70.012.0630.11	630X57,2 SDR11 ISO S-5	630	57,2	175	642	685	60	21.84
710	70.012.0710.11	710X64,5 SDR11 ISO S-5	710	64,5	170	737	800	65	29.4