

Fittings

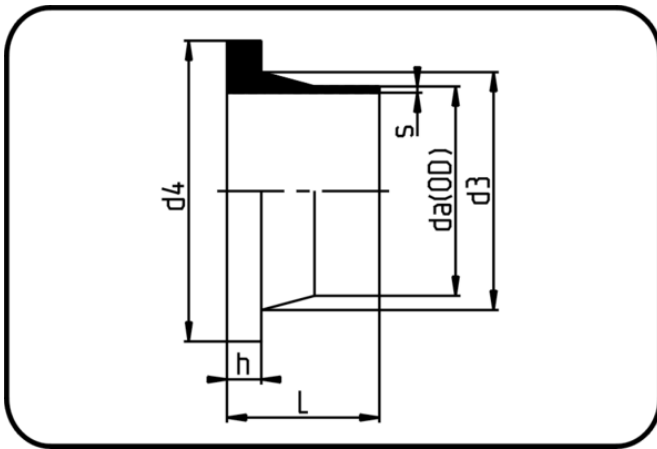

Code: 012

- **Stub Flange DIN**

- short spigot
- injection moulded

- **Butt+IR-welding**

- **PP Pure grey**

Backing Rings please see Accessories.

Dimension	Code	Detail	da(OD) mm	s mm	L mm	d3 mm	d4 mm	h mm	Weight
20	72.012.0020.11	20X1,9 SDR11 ISO S-5	20	1,9	52	27	45	7	0.015
25	72.012.0025.11	25X2,3 SDR11 ISO S-5	25	2,3	52	33	58	9	0.027
32	72.012.0032.11	32X2,9 SDR11 ISO S-5	32	2,9	50	40	68	10	0.042
40	72.012.0040.11	40X3,7 SDR11 ISO S-5	40	3,7	52	50	78	11	0.061
50	72.012.0050.11	50X4,6 SDR11 ISO S-5	50	4,6	53	61	88	12	0.085
63	72.012.0063.11	63X5,8 SDR11 ISO S-5	63	5,8	50	75	102	14	0.119
75	72.012.0075.11	75X6,8 SDR11 ISO S-5	75	6,8	50,5	89	122	16	0.191
90	72.012.0090.11	90X8,2 SDR11 ISO S-5	90	8,2	82	105	138	17	0.307
110	72.012.0110.11	110X10,0 SDR11 ISO S-5	110	10	82	125	158	18	0.441
125	72.012.0125.11	125X11,4 SDR11 ISO S-5	125	11,4	80	132	158	25	0.488
140	72.012.0140.11	140X12,7 SDR11 ISO S-5	140	12,7	92	155	188	25	0.763
160	72.012.0160.11	160X14,6 SDR11 ISO S-5	160	14,6	92	175	212	25	0.972
180	72.012.0180.11	180X16,4 SDR11 ISO S-5	180	16,4	93	183	212	30	0.994
200	72.012.0200.11	200X18,2 SDR11 ISO S-5	200	18,2	114	232	268	32	2.14
225	72.012.0225.11	225X20,5 SDR11 ISO S-5	225	20,5	113	235	268	32	2.03
250	72.012.0250.11	250X22,7 SDR11 ISO S-5	250	22,7	130	285	320	35	3.4
280	72.012.0280.11	280X25,4 SDR11 ISO S-5	280	25,4	128	288	320	35	2.67
315	72.012.0315.11	315X28,6 SDR11 ISO S-5	315	28,6	136	335	370	35	4.576