

Fittings

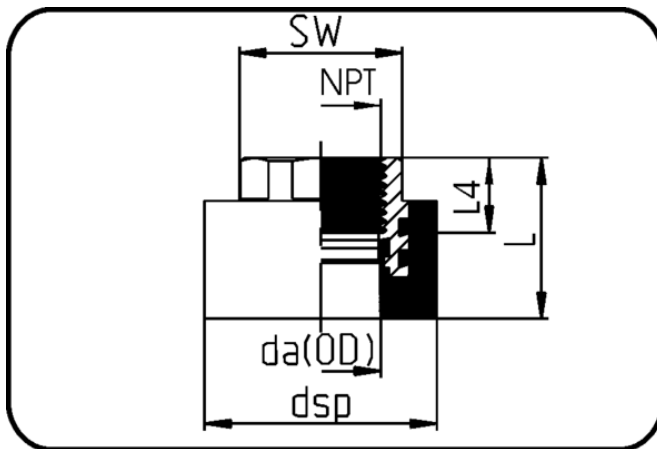

Code: 22.082.1

- **Adaptor**
- NPT metal female thread+hexag.
- injection moulded
- **Socket-welding**
- **PE 100 blue**

Dimension	Code	Detail	da(OD) mm	L mm	SW mm	dsp mm	Weight
20	22.082.2021.07	20X1/2" - MOP 16 bar	20	41	32	42	0.141
25	22.082.2526.07	25X3/4" - MOP 16 bar	25	41	36	46	0.158
32	22.082.3233.07	32X1" - MOP 16 bar	32	46	39	53	0.21
40	22.082.4041.07	40X1 1/4" - MOP 16 bar	40	51	50	65,5	0.35
50	22.082.5051.07	50X1 1/2" - MOP 16 bar	50	58	60	77,4	0.58
63	22.082.6364.07	63X2" - MOP 16 bar	63	65	70	90,5	0.773