

Fittings with short Spigot

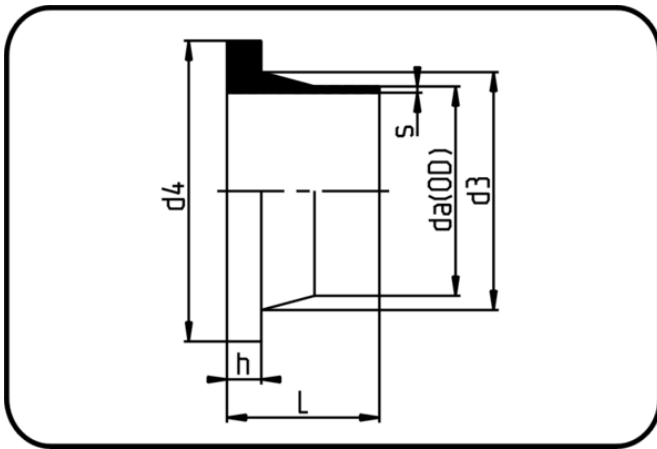

Code: 012.1

- **Stub Flange ANSI**
- short spigot
- injection moulded
- **Butt-welding**
- **PPR grey**

Backing Rings please see Accessories.

Dimension	Code	Detail	da(OD) mm	s mm	L mm	d3 mm	d4 mm	h mm	Weight
20	11.012.1020.11	20X1,9 SDR11 ISO S-5	20	1,9	52	27	44,5	7	0.015
25	11.012.1025.11	25X2,3 SDR11 ISO S-5	25	2,3	52	33	54,1	9	0.024
32	11.012.1032.11	32X2,9 SDR11 ISO S-5	32	2,9	50	40	63,5	10	0.036
40	11.012.1040.11	40X3,7 SDR11 ISO S-5	40	3,7	52	50	71,5	11	0.051
50	11.012.1050.11	50X4,6 SDR11 ISO S-5	50	4,6	53	61	82,55	12	0.076
63	11.012.1063.11	63X5,8 SDR11 ISO S-5	63	5,8	50	75	100,4	14	0.117
75	11.012.1075.11	75X6,8 SDR11 ISO S-5	75	6,8	50,5	89	117	16	0.172
90	11.012.1090.11	90X8,2 SDR11 ISO S-5	90	8,2	82	105	132,4	17	0.296
110	11.012.1110.11	110X10,0 SDR11 ISO S-5	110	10	82	125	158	18	0.439
125	11.012.1125.11	125X11,4 SDR11 ISO S-5	125	11,4	80	132	158	25	0.491
160	11.012.1160.11	160X14,6 SDR11 ISO S-5	160	14,6	92	175	212	25	0.96
200	11.012.1200.11	200X18,2 SDR11 ISO S-5	200	18,2	114	232	268	32	2.04
225	11.012.1225.11	225X20,5 SDR11 ISO S-5	225	20,5	113	235	268	32	1.96
250	11.012.1250.11	250X22,7 SDR11 ISO S-5	250	22,7	130	285	320	35	3.32
315	11.012.1315.11	315X28,6 SDR11 ISO S-5	315	28,6	136	335	370	35	3.6
355	11.012.1355.11	355x32,2 SDR11 ISO S-5	355	32,2	150	373	430	40	6.48
400	11.012.1400.11	400X36,3 SDR11 ISO S-5	400	36,3	155	427	482	46	8.57
450	11.012.1450.11	450X40,9 SDR11 ISO S-5	450	40,9	165	492	545	60	12.8