

Fittings with short Spigot

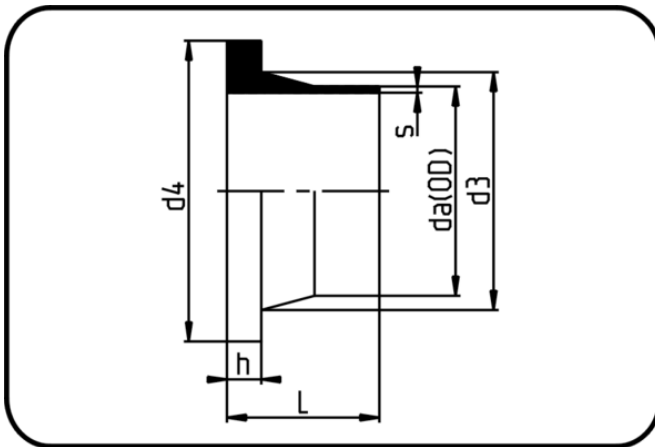

Code: 012

- **Stub Flange DIN**
- short spigot
- electrically conductive
- injection moulded
- **Butt-welding**
- **HDPE-el black**

Dimension	Code	Detail	da(OD) mm	s mm	L mm	d3 mm	d4 mm	h mm	Weight
110	28.012.0110.33	110X3,4 SDR33 ISO S-16	110	3,4	80	125	158	18	0.32
125	28.012.0125.33	125X3,9 SDR33 ISO S-16	125	3,9	80	132	158	18	0.301
160	28.012.0160.33	160X4,9 SDR33 ISO S-16	160	4,9	80	175	212	18	0.595
180	28.012.0180.33	180X5,5 SDR33 ISO S-16	180	5,5	92	183	212	18	0.513
200	28.012.0200.33	200X6,2 SDR33 ISO S-16	200	6,2	113	232	268	18	1.038
225	28.012.0225.33	225X6,9 SDR33 ISO S-16	225	6,9	113	235	268	18	0.914
250	28.012.0250.33	250X7,7 SDR33 ISO S-16	250	7,7	132	285	320	20	1.98
315	28.012.0315.33	315X9,7 SDR33 ISO S-16	315	9,7	136	335	370	20	2.378
355	28.012.0355.33	355X10,9 SDR33 ISO S-16	355	10,9	120	373	430	23	3.02
400	28.012.0400.33	400X12,3 SDR33 ISO S-16	400	12,3	155	427	482	26	4.3
110	28.012.0110.17	110X6,6 SDR17 ISO S-8	110	6,6	80	125	158	18	0.409
125	28.012.0125.17	125X7,4 SDR17 ISO S-8	125	7,4	84	132	158	18	0.383
160	28.012.0160.17	160X9,5 SDR17 ISO S-8	160	9,5	92	175	212	18	0.78
180	28.012.0180.17	180X10,7 SDR17 ISO S-8	180	10,7	92	183	212	20	0.76
200	28.012.0200.17	200X11,9 SDR17 ISO S-8	200	11,9	110	232	268	24	1.655
225	28.012.0225.17	225X13,4 SDR17 ISO S-8	225	13,4	112,5	235	268	24	1.54
250	28.012.0250.17	250X14,8 SDR17 ISO S-8	250	14,8	132	285	320	25	2.74
315	28.012.0315.17	315X18,7 SDR17 ISO S-8	315	18,7	136	335	370	25	3.6
32	28.012.0032.11	32X3,0 SDR11 ISO S-5	32	3	50	40	68	10	0.046
40	28.012.0040.11	40X3,7 SDR11 ISO S-5	40	3,7	50	50	78	11	0.067
50	28.012.0050.11	50X4,6 SDR11 ISO S-5	50	4,6	53	61	88	12	0.095
63	28.012.0063.11	63X5,8 SDR11 ISO S-5	63	5,8	50	75	102	14	0.137
75	28.012.0075.11	75X6,8 SDR11 ISO S-5	75	6,8	50,5	89	122	16	0.209

Dimension	Code	Detail	da(OD) mm	s mm	L mm	d3 mm	d4 mm	h mm	Weight
90	28.012.0090.11	90X8,2 SDR11 ISO S-5	90	8,2	80	105	138	17	0.353
110	28.012.0110.11	110X10,0 SDR11 ISO S-5	110	10	80	125	158	18	0.49
125	28.012.0125.11	125X11,4 SDR11 ISO S-5	125	11,4	80	132	158	25	0.533
160	28.012.0160.11	160X14,6 SDR11 ISO S-5	160	14,6	92	175	212	25	1.08
180	28.012.0180.11	180X16,4 SDR11 ISO S-5	180	16,4	93	183	212	30	1.135
200	28.012.0200.11	200X18,2 SDR11 ISO S-5	200	18,2	114	232	268	32	2.32
225	28.012.0225.11	225X20,5 SDR11 ISO S-5	225	20,5	113	235	268	32	2.22
250	28.012.0250.11	250X22,7 SDR11 ISO S-5	250	22,7	130	285	320	35	3.74
315	28.012.0315.11	315X28,6 SDR11 ISO S-5	315	28,6	136	335	370	35	5.18