

Fittings

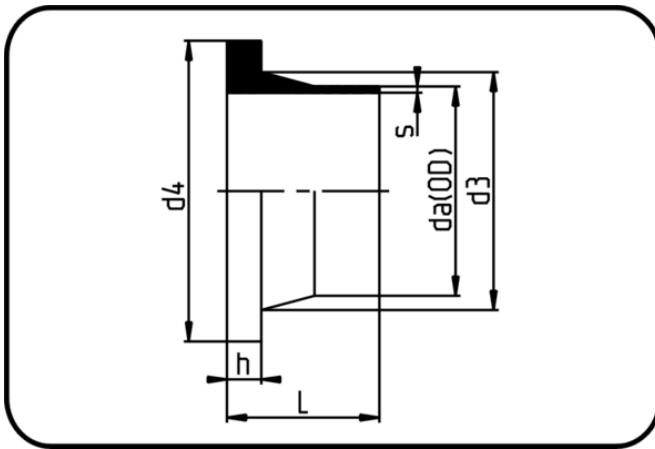

Code: 012.2

- **Stub Flange JIS**
- short spigot
- injection moulded
- **Butt+IR-welding**
- **PVDF UHP natural**

Backing Rings please see Accessories.

Dimension	Code	Detail	da(OD) mm	s mm	L mm	d3 mm	d4 mm	h mm	Weight
90	35.012.2090.33	90X2,8 SDR33 ISO S-16	90	2,8	80	105	129	11	0.38
110	35.012.2110.33	110X3,4 SDR33 ISO S-16	110	3,4	80	125	154	12	0.418
125	35.012.2125.33	125X3,9 SDR33 ISO S-16	125	3,9	80	132	154	14	0.515
140	35.012.2140.33	140X4,3 SDR33 ISO S-16	140	4,3	80	155	185	15	0.636
160	35.012.2160.33	160X4,9 SDR33 ISO S-16	160	4,9	81	175	212	16	0.982
200	35.012.2200.33	200X6,2 SDR33 ISO S-16	200	6,2	100	232	265	18	2.188
225	35.012.2225.33	225X6,9 SDR33 ISO S-16	225	6,9	100	235	265	18	1.395
250	35.012.2250.33	250X7,7 SDR33 ISO S-16	250	7,7	100	285	320	20	3.1
280	35.012.2280.33	280X8,6 SDR33 ISO S-16	280	8,6	100	288	320	20	2.57
20	35.012.2020.21	20X1,9 SDR21 ISO S-10	20	1,9	49	27	45	6	0.029
25	35.012.2025.21	25X1,9 SDR21 ISO S-10	25	1,9	50	33	58	6,5	0.045
32	35.012.2032.21	32X2,4 SDR21 ISO S-10	32	2,4	50	40	68	7	0.062
40	35.012.2040.21	40X2,4 SDR21 ISO S-10	40	2,4	50	50	78	8	0.082
50	35.012.2050.21	50X3,0 SDR21 ISO S-10	50	3	50	61	84	9	0.125
63	35.012.2063.21	63X3,0 SDR21 ISO S-10	63	3	50	76	99	10	0.165
75	35.012.2075.21	75X3,6 SDR21 ISO S-10	75	3,6	50	89	119	10	0.214
90	35.012.2090.21	90X4,3 SDR21 ISO S-10	90	4,3	80	105	129	11	0.371
110	35.012.2110.21	110X5,3 SDR21 ISO S-10	110	5,3	80	125	154	12	0.52
125	35.012.2125.21	125X6,0 SDR21 ISO S-10	125	6	80	132	154	14	0.67
140	35.012.2140.21	140X6,7 SDR21 ISO S-10	140	6,7	80	155	185	15	0.82
160	35.012.2160.21	160X7,7 SDR21 ISO S-10	160	7,7	81	175	212	16	1.071
200	35.012.2200.21	200X9,6 SDR21 ISO S-10	200	9,6	100	232	265	20	2.4

Dimension	Code	Detail	da(OD) mm	s mm	L mm	d3 mm	d4 mm	h mm	Weight
225	35.012.2225.21	225X10,8 SDR21 ISO S-10	225	10,8	100	235	265	20	1.825
250	35.012.2250.21	250X11,9 SDR21 ISO S-10	250	11,9	100	285	320	22	3.55
280	35.012.2280.21	280X13,4 SDR21 ISO S-10	280	13,4	100	288	320	25	2.99
315	35.012.2315.21	315X15,0 SDR21 ISO S-10	315	15	102	335	370	25	4.5