

## Fittings

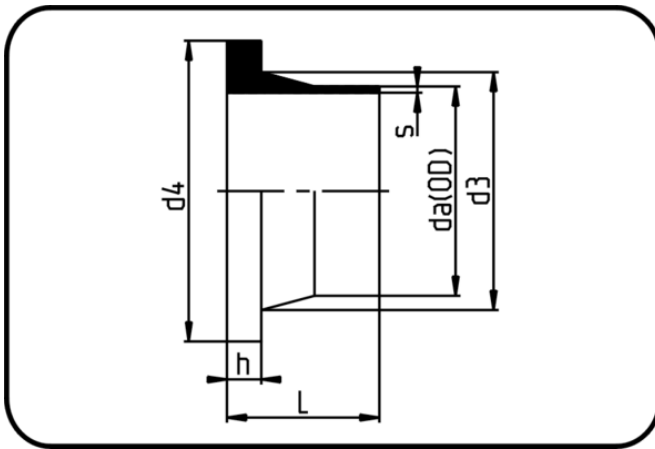

Code: 012

- **Stub Flange DIN**
- short spigot
- injection moulded
- **Butt+IR-welding**
- **PVDF UHP natural**

Backing Rings please see Accessories.

Dimension	Code	Detail	da(OD) mm	s mm	L mm	d3 mm	d4 mm	h mm	Weight
90	35.012.0090.33	90X2,8 SDR33 ISO S-16	90	2,8	80	105	138	11	0.352
110	35.012.0110.33	110X3,4 SDR33 ISO S-16	110	3,4	80	125	158	12	0.463
125	35.012.0125.33	125X3,9 SDR33 ISO S-16	125	3,9	80	132	158	14	0.475
140	35.012.0140.33	140X4,3 SDR33 ISO S-16	140	4,3	80	155	188	15	0.68
160	35.012.0160.33	160X4,9 SDR33 ISO S-16	160	4,9	81	175	212	16	0.941
180	35.012.0180.33	180X5,5 SDR33 ISO S-16	180	5,5	80	183	212	18	0.85
200	35.012.0200.33	200X6,2 SDR33 ISO S-16	200	6,2	100	232	268	18	1.94
225	35.012.0225.33	225X6,9 SDR33 ISO S-16	225	6,9	100	235	268	18	1.381
250	35.012.0250.33	250X7,7 SDR33 ISO S-16	250	7,7	100	285	320	20	2.68
280	35.012.0280.33	280X8,6 SDR33 ISO S-16	280	8,6	100	288	320	20	2.15
315	35.012.0315.33	315X9,7 SDR33 ISO S-16	315	9,7	100	335	370	20	3.121
20	35.012.0020.21	20X1,9 SDR21 ISO S-10	20	1,9	49	27	45	6	0.027
25	35.012.0025.21	25X1,9 SDR21 ISO S-10	25	1,9	50	33	58	6,5	0.042
32	35.012.0032.21	32X2,4 SDR21 ISO S-10	32	2,4	50	40	68	7	0.042
40	35.012.0040.21	40X2,4 SDR21 ISO S-10	40	2,4	50	50	78	8	0.091
50	35.012.0050.21	50X3,0 SDR21 ISO S-10	50	3	50	61	88	9	0.126
63	35.012.0063.21	63X3,0 SDR21 ISO S-10	63	3	50	76	102	10	0.173
75	35.012.0075.21	75X3,6 SDR21 ISO S-10	75	3,6	50	89	122	10	0.23
90	35.012.0090.21	90X4,3 SDR21 ISO S-10	90	4,3	80	105	138	11	0.4
110	35.012.0110.21	110X5,3 SDR21 ISO S-10	110	5,3	80	125	158	12	0.535
125	35.012.0125.21	125X6,0 SDR21 ISO S-10	125	6	80	132	158	14	0.628
140	35.012.0140.21	140X6,7 SDR21 ISO S-10	140	6,7	80	155	188	15	0.806

Dimension	Code	Detail	da(OD) mm	s mm	L mm	d3 mm	d4 mm	h mm	Weight
160	35.012.0160.21	160X7,7 SDR21 ISO S-10	160	7,7	81	175	212	16	1.13
180	35.012.0180.21	180X8,6 SDR21 ISO S-10	180	8,6	80	183	212	18	1.069
200	35.012.0200.21	200X9,6 SDR21 ISO S-10	200	9,6	100	232	268	20	2.32
225	35.012.0225.21	225X10,8 SDR21 ISO S-10	225	10,8	100	235	268	20	1.95
250	35.012.0250.21	250X11,9 SDR21 ISO S-10	250	11,9	100	285	320	22	3.57
280	35.012.0280.21	280X13,4 SDR21 ISO S-10	280	13,4	100	288	320	25	3.01
315	35.012.0315.21	315X15,0 SDR21 ISO S-10	315	15	102	335	370	25	4.46