

knie 90°, PE100 SDR17/17,6

- lang spie-eind uitvoering
- 5 bar gas / 10 bar water

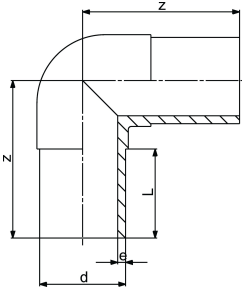

d (mm)	code	SP	gewicht (kg)	PF	z (mm)	L (mm)	e (mm)	PSI
90	753 100 813	1	0,543	2 51 301 001	150	81	5,4	130
110	753 100 814	1	0,876	2 51 301 001	165	86	6,6	130
125	753 100 815	1	0,927	2 51 301 001	180	93	7,4	130
140	753 100 816	1	1,547	2 51 301 001	194	92	8,3	130
160	753 100 817	1	2,385	2 51 301 001	210	102	9,5	130
180	753 100 818	1	3,205	2 51 301 001	232	107	10,7	130
200	753 100 819	1	4,298	2 51 301 001	253	115	11,9	130
225	753 100 820	1	5,864	2 51 301 001	270	120	13,4	130
250	753 100 821	1	8,000	2 51 301 002	292	130	14,8	130
280	753 100 822	1	11,328	2 51 301 002	320	140	16,6	
315	753 100 823	1	15,877	2 51 301 002	370	150	18,7	

The technical data are not binding. They neither constitute expressly warranted characteristics nor guaranteed properties nor a guaranteed durability. They are subject to modification. Our General Terms of Sale apply.

Georg Fischer Piping Systems Ltd, Postfach, CH-8201 Schaffhausen/Switzerland

Phone +41 -(0)52-631 1111

e-mail: info.ps@georgfischer.com

Internet: <http://www.gfps.com>