

Data sheet

valid from: 9/20/16



Tee 45° ABS Inch BS

d (inch)	PN (bar)	Code	SP	Weight (kg)	D (mm)	L (mm)	L1 (mm)	z (mm)	z1 (mm)
½	9	729 251 106	10	0.026	28	68	46	30	6
¾	9	729 251 107	10	0.039	33	83	55	36	9
1	9	729 251 108	10	0.068	41	99	67	45	10
1 ¼	9	729 251 109	10	0.109	50	118	82	55	9
1 ½	9	729 251 110	5	0.207	60	140	97	67	13
2	9	729 251 111	10	0.372	74	175	123	87	16
2 ½	6	729 250 112	5	0.605	91	207	145	101	18

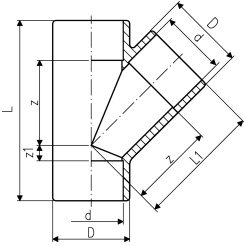

The technical data are not binding. They neither constitute expressly warranted characteristics nor guaranteed properties nor a guaranteed durability. They are subject to modification. Our General Terms of Sale apply.

Georg Fischer Piping Systems Ltd, Postfach, CH-8201 Schaffhausen/Switzerland

Phone +41 -(0)52-631 1111

e-mail: info.ps@georgfischer.com

Internet: <http://www.gfps.com>