

## Fittings

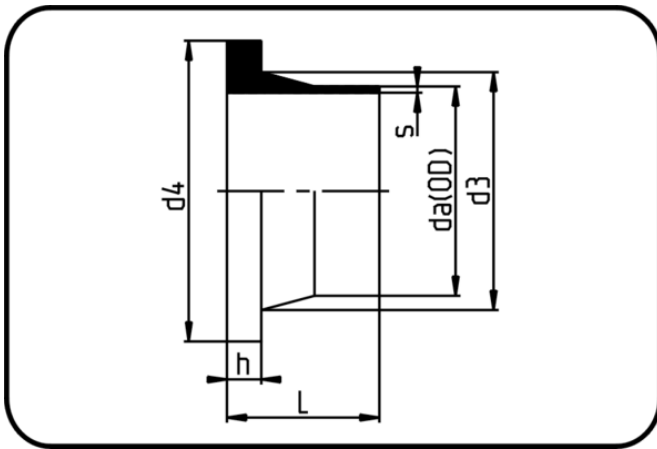

Code: 012

- **Stub Flange DIN**
- short spigot
- injection moulded
- **Butt+IR-welding**
- **ECTFE natural**

Backing Rings please see Accessories.

Dimension	Code	Detail	da(OD) mm	s mm	L mm	d3 mm	d4 mm	h mm	Weight
20	40.012.0020.21	20X1,9 SDR21 ISO S-10	20	1,9	49	27	45	6	0.028
25	40.012.0025.21	25X1,9 SDR21 ISO S-10	25	1,9	50	33	58	6,5	0.045
32	40.012.0032.21	32X2,4 SDR21 ISO S-10	32	2,4	50	40	68	7	0.039
50	40.012.0050.21	50X3,0 SDR21 ISO S-10	50	3	50	61	88	9	0.119
63	40.012.0063.21	63X3,0 SDR21 ISO S-10	63	3	50	76	102	10	0.163
90	40.012.0090.21	90X4,3 SDR21 ISO S-10	90	4,3	80	105	138	11	0.384
110	40.012.0110.21	110X5,3 SDR21 ISO S-10	110	5,3	80	125	158	12	0.507